



## S.S. BEATRICE

DANUBE RIVER

INAUGURATED 2009; RENOVATED 2018  
GUESTS 152; STAFF 55

# DELIGHTFULLY DIVINE.

*Beatrice is a beauty.*

The **S.S. Beatrice** showcases the best in luxury river cruising after her stunning bow-to-stern transformation. She boasts a fresh, sleek look including a graceful new bow, yacht-like finishes throughout, an elegant grand staircase, two additional dining venues, two new Grand Suites, a second 390-square-foot Royal Suite, and several adjoining rooms, perfect for families traveling together. Original art includes works by Pablo Picasso, Alexander Calder and Pino Signoretto.

## SUITES AND STATEROOMS

**LAVISHLY APPOINTED RIVERVIEW STATEROOMS AND SUITES** have handcrafted Savoir® beds of England draped in the finest linens with a menu of pillow choices.

**STATEROOM AND SUITE AMENITIES INCLUDE** built-in closets, hair dryer, safe, individual climate-control thermostat and a flat-screen TV with infotainment center.

**MARBLE BATHROOMS INCLUDE** Hermès bath and body products, plush towels, special towel warmers, backlit magnifying mirror, heated mirrors, cozy bathrobes and slippers, separate rain shower and tub and a secluded toilet area.

**SUITES ARE UNIQUELY DECORATED AND HAVE ADDITIONAL AMENITIES AND SERVICES, INCLUDING** in-suite butler service; packing and unpacking assistance; daily fruit and cookie plate, an evening snack; Nespresso coffee machine and fine teas; fully stocked minibar; bottle of wine upon arrival; and free laundry service.

## SHIP SNAPSHOT:

- Royal Suites: 2 (390 ft<sup>2</sup> / 32 m<sup>2</sup>)
- Grand Suites: 2 (310 ft<sup>2</sup> / 29 m<sup>2</sup>)
- Suites: 12 (225 ft<sup>2</sup> / 21 m<sup>2</sup>)
- Deluxe French Balcony: 13 (150 ft<sup>2</sup> / 15 m<sup>2</sup>)
- French Balcony: 37 (150 ft<sup>2</sup> / 15 m<sup>2</sup>)
- Classic: 10 (150 ft<sup>2</sup> / 15 m<sup>2</sup>)
- Length: 430 ft / 131 m
- Width: 37.5 ft / 11.4 m
- Voltage: 110/220 volts

## PUBLIC AREAS AND AMENITIES

- Four dining options all inspired by famous Austrian composers
  - Mozart's
  - Wolfgang's bar and lounge
  - Schubert's
  - Max's
- 24-hour specialty tea and coffee station
- Well-equipped fitness center
- Elevator
- Guest laundry
- Free Internet and Wi-Fi access

**NOTE:** All suites on the Rhine Deck have French balconies. Grand Suites 400 and 401 have fixed beds that cannot be separated. Designated adjoining staterooms are available.

CST #2075415-20



TICO Reg. #50018458

Royal Suite (390 sq ft / 36.2 sq m)

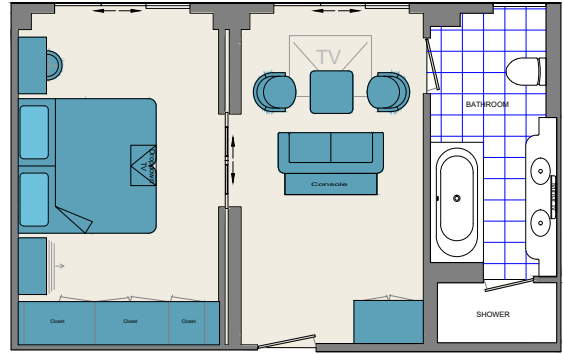

Grand (Owner's) Suite (310 sq ft / 28.8 sq m)

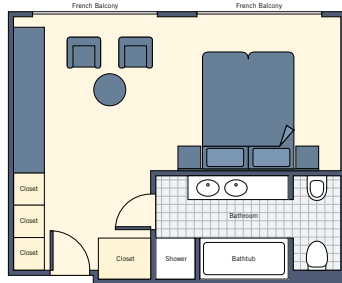

Suite (225 sq ft / 21 sq m)

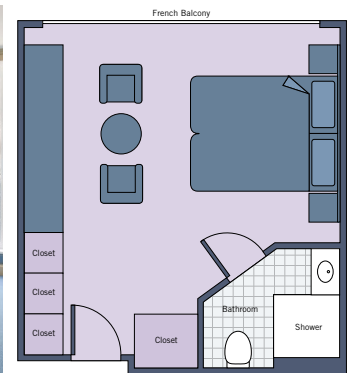

Deluxe French Balcony (Category 1) (150 sq ft / 14 sq m)

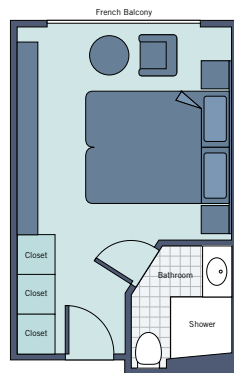

French Balcony (Category 2-3) (150 sq ft / 14 sq m)

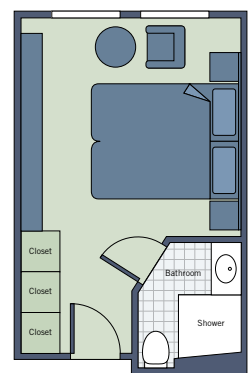

**NOTE:** All suites on the Rhine Deck have French balconies. Grand Suites 400 and 401 have fixed beds that cannot be separated. Designated adjoining staterooms are available.

CST #2075415-20



TICO Reg. #50018458

Mozart's



Max's



Schubert's



Wolfgang's



Lobby and Grand Staircase

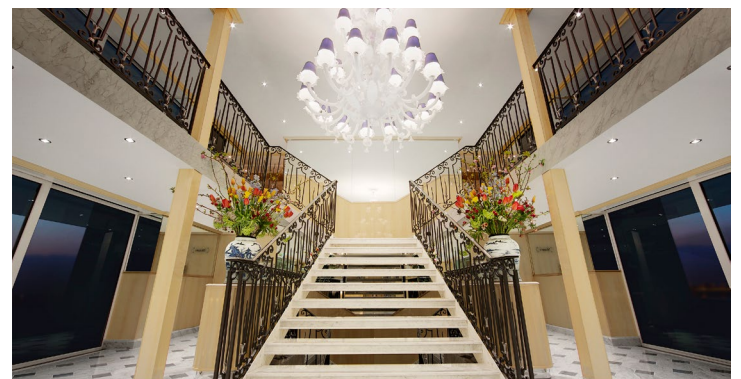

**NOTE:** All suites on the Rhine Deck have French balconies. Grand Suites 400 and 401 have fixed beds that cannot be separated. Designated adjoining staterooms are available.

CST #2075415-20



TICO Reg. #50018458

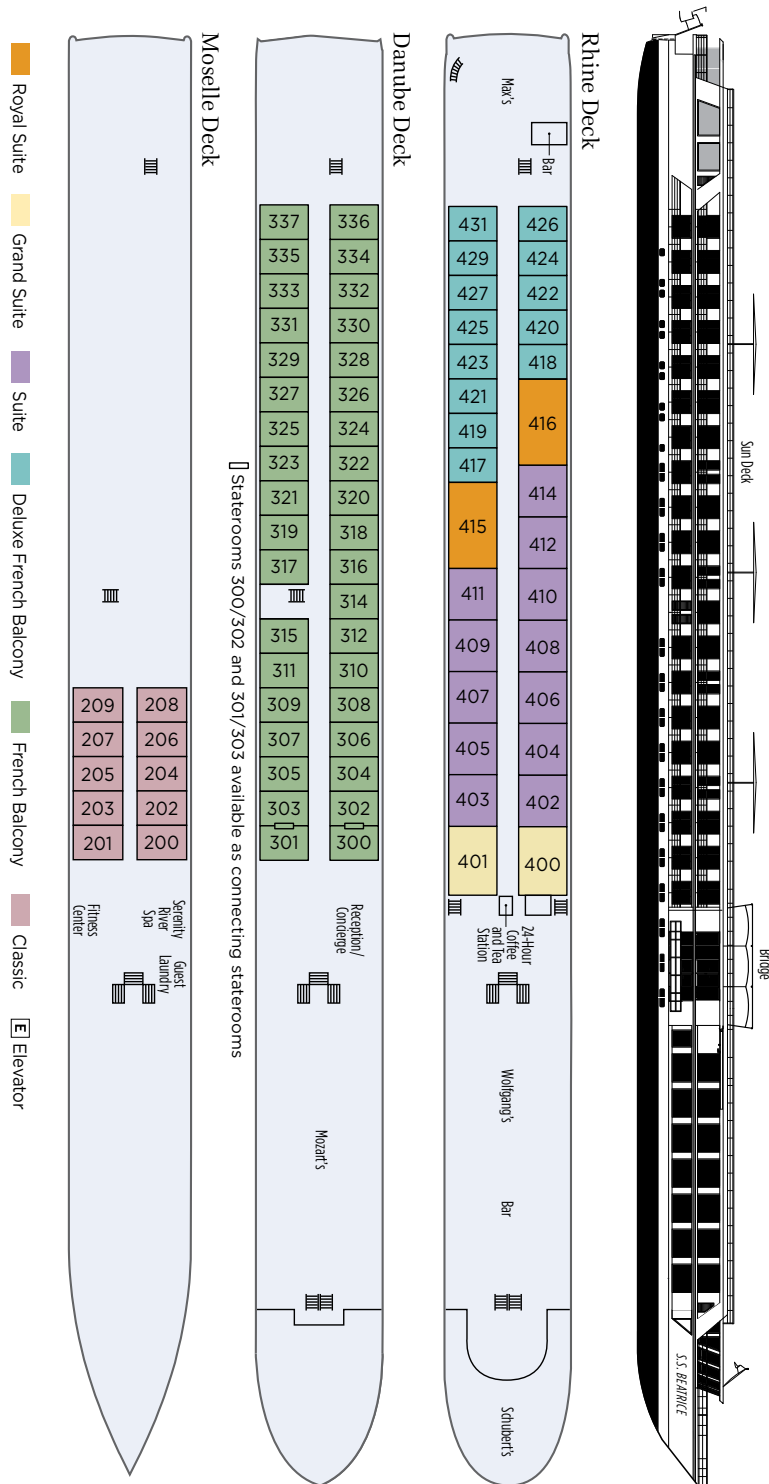

**NOTE:** All suites on the Rhine Deck have French balconies. Grand Suites 400 and 401 have fixed beds that cannot be separated. Designated adjoining staterooms are available.

CST #2075415-20



TICO Reg. #50018458