



The **Villager**

Issue 7 • 2020

HOW TO BRIDGE THE DIGITAL DIVIDE

**Estate Rules
for Businesses**

**DARE TO LOVE
Donations Drive**

Please respect our 40 km/h Speed Limit

THE BRANDS YOU WANT

THE PRICES YOU'LL LOVE THIS WINTER



Visit our website [atterburyvaluemart.co.za](https://www.atterburyvaluemart.co.za) for a full list of clothing stores trading during lock down.



#avmshopping

atterbury
value mart

Contents

Message from the Estate Office	3
DARE TO LOVE Donations Drive	6
Financials	8
Chess by Knight	10
Collaborative Community Networks	14
James Clarke:	
Are Women really from Venus?	16
Smalls	18
Accredited Estate Agents	19
Important Contact Numbers	19
Irene Service Providers	20

Cover photo by Marchell Galant

The Villager focuses on Irene Farm Villages. The magazine is delivered to the home of each resident on the Estate. The magazine is co-ordinated and published by Estates in Africa (Pty) Ltd on behalf of the Home Owners' Association of Irene Farm Villages. The opinions of workers and personnel of Estates in Africa (Pty) Ltd do not necessarily reflect those of the HOA of Irene Farm Villages.

Publisher

Nico Maritz

E-mail: nico@eiapublishing.co.za

Editor

Bev Hermanson

E-mail: bev@eiapublishing.co.za

Sales Manager & Advertising

Martin Fourie - Cell: 072 835 8405

E-mail: martin@eiapublishing.co.za

Office: 012 997 2712

Sales

Frans Meyer - Cell: 072 267 3141

E-mail: fransm@nowmedia.co.za

Production Co-ordinator

Chris Grant

E-mail: chrisg@nowmedia.co.za

Graphic Design

Diane van Noort

E-mail: d2vn@mweb.co.za

ESTATES IN AFRICA (PTY) LTD HEAD OFFICE:

Tel: 011 327 4062

32 Fricker Road, Illovo, Johannesburg

www.eiapublishing.co.za

Deadline for advertisements and editorial contributions:

13 July 2020



(Pty) Ltd



"YOUR TRUSTED PROPERTY PROFESSIONAL"

Léane Graaff Properties

R3 695mil New on the market



This dual mandated Industrial finished home is perfect for the extended family and entertainer. 4beds, 4 baths, DQ, brand new kitchen, braai patio, Jacuzzi, built in bar, gas fireplace, boma and too much to mention. Call me today for a viewing

To Let 30k per month Available from 1st August 2020



For the extended family, 4 beds all en suite, 3 garages, lots of parking, pool, DQ study, fire place, spacious stand.

UNDER OFFER

**SOLD within 72 hours
BY LEANE**



**Properties urgently
needed for
approved buyers!**

Excellence, Professionalism, Results • Cell: 083 457 3184 • r.graaff@absamail.co.za

Exclusive Mandate Property Showcase

Irene Farm Villages

Centurion office +27 (0)12 644 8300 • centurion@pamgolding.co.za



Peter Varrie

"Peter's generosity with advice, and his patience with me as I went back and forth making a decision on whether or not to take the property was much appreciated. His kindness and honesty was refreshing. It still is."

Mbali Mtshali

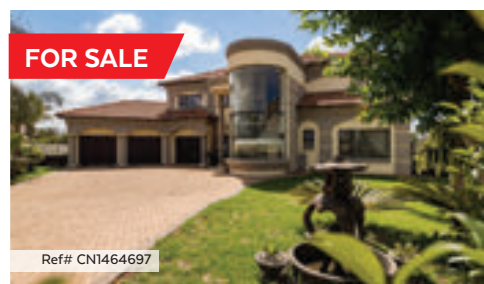

R6.3 million

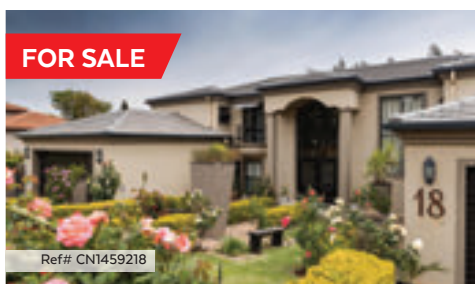

R4.999 million

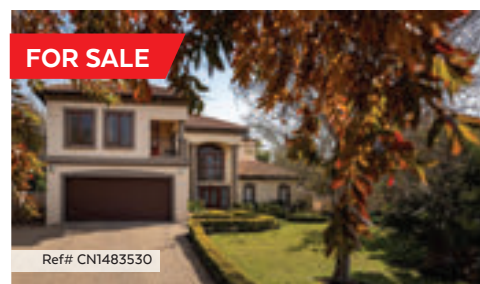

R4.1 million

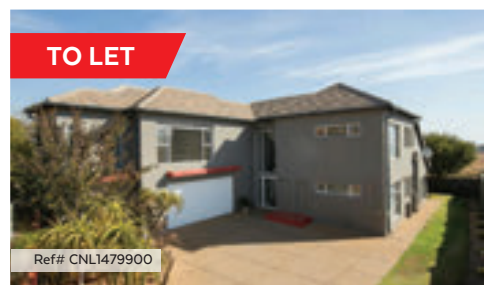

R28 000pm



R4.35 million



R4.6 million

Pam Golding Properties is the top selling agency in Africa and Peter Varrie is a valued Gold Club Member and a top selling Property Professional in Irene Farm Villages. We invite you to join his rapidly growing band of satisfied sellers and buyers.

Peter Varrie 082 457 7416 • peter.varrie@pamgolding.co.za

pamgolding.co.za



Dear Residents

As the COVID-19 pandemic progresses, many a word has been spoken, and stories told of the pandemic worldwide, to the extent that little of what was said really made sense to me, maybe because of the many contradictory statements. However, the pandemic is indeed a reality. Months into the pandemic, I still wrestle with the thought of what the most important lesson is that I have learnt from the pandemic: was that patience, or to live a more simplistic life, or to be disciplined? However, one thing is certain and that is that the pandemic brought about tangible changes to our daily lives.

All the service providers of the Homeowners' Association are still strictly bound by the COVID-19 Lockdown Regulations, especially the occupational health and safety regulations, for example the wearing of masks, social distancing, daily temperature measuring and the regular washing of hands and sanitising of the work area. Although the Estate Office is open, we urge residents to make enquiries via e-mail or telephone, before visiting the office. This will minimise the contact between persons, which is of utmost importance. We also appeal to our residents and all their visitors, including contractors and deliveries, to comply with the COVID-19 Regulations. It is the responsibility of each homeowner to ensure that their household worker(s) are safe and healthy. At the end of the day, it is in the best interests of all of us.

It has come to the attention of the Home Owners Association that lately, more and more people are working from home or have started home-



At van Niekerk

based businesses because of the COVID-19 pandemic. Residents are reminded that no business may be conducted from your home unless the business has been approved by the Board of Directors. Your attention is drawn to the prescription of Rules 4.4.10, 11 and 12. All applications must be submitted to the Estate Manager, who will forward them to the Board for review and consideration. The effect that a business may have on the security system plays an important part in the approval of such a business. The Board is very mindful of an influx of non-residential people into the estate because of business activities.

There were no security breaches during the past month, neither the penetration of the estate perimeter fence nor incidents inside the estate. The security technology is functioning well and is also well maintained by

the different service suppliers, namely Bidvest Protea Coin and XON Solutions. In both instances there are long term maintenance contracts in place.

The Infrastructure Development Plan (IDP), which makes provision for the upgrading of the two gatehouses and the contractors' yard, is still in progress. The building plans for the main gatehouse building must still be approved by the Tshwane Municipality. However, due to the COVID-19 lockdown, there is a delay with the approval of the plans. In the meantime, the building contractors to be invited to tender were identified and the tender process started on 24 June 2020, when 9 building contractors were invited to attend the first tender meeting. (Please see the new building plans on the following page).

The finances of the Home Owners Association reflect a positive picture after the first three months of the national lockdown. Due to the economic uncertainty that was brought about by the COVID-19 pandemic, the following operational expenditures for the current financial year were suspended by the HOA Board, namely:

- Maintenance and painting of the 4.5km perimeter palisade fence.
- Additional speed humps.
- Mountain bike track.
- Surveillance cameras and facial recognition equipment.
- Non-essential equipment and expenses.

The Tshwane Municipality indicated that its appointed contractors will be starting on 15 July 2020 with the rehabilitation of the existing sinkhole in Queens Way. This sinkhole developed in March 2015 and since then the HOA Board of Directors has been in constant discussions with the Municipality to commence with the rehabilitation. The date of commencement has been



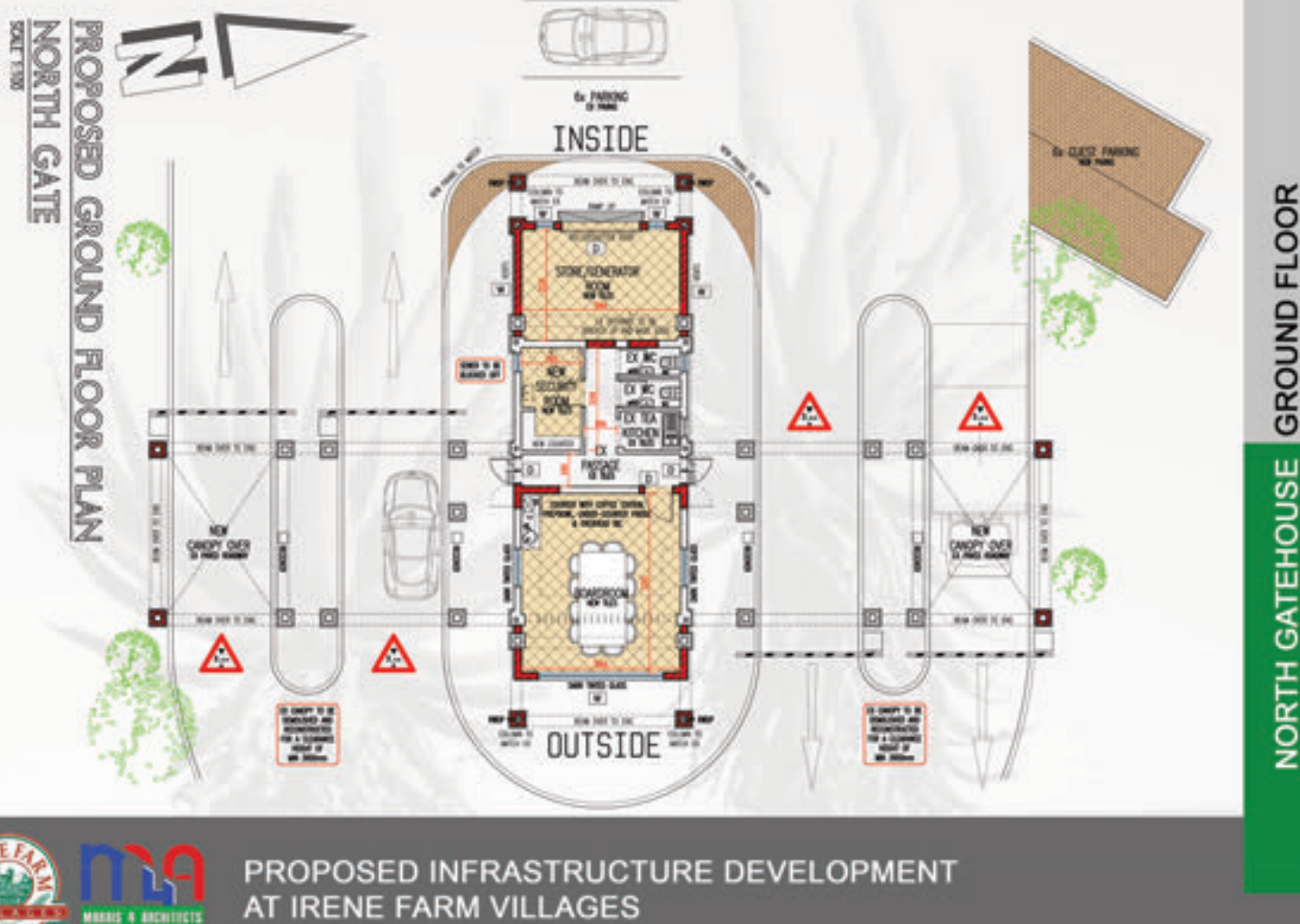

Queens Way sinkhole

moved back on the priority list time and time again, to the frustration of the Irene Farm Villages HOA and the residents. We trust that the Municipality will now start and complete this long outstanding project. Due to the nature of the rehabilitation, there will be movement of big construction machinery in the estate for the next few months..

With the COVID-19 lockdown came the closing of all the schools. As time moved on, many scholars had access to internet-schooling, however other scholars, especially those in the rural areas, did not have this convenience. The University of Johannesburg, through its Centre for Collaborative Digital Networks, identified this shortcoming and came up with a

solution in the form of a small server that will enable scholars in the rural areas of South Africa to have access to educational material. The Head of this Centre, Dr Reolyn Heymann agreed to share the development and implementation of this new project with us. The first of three articles is published in this issue. Interested persons are welcome to contact Dr Heymann at reymann@uj.ac.za.

The Knight is back in this issue with interesting ideas on how to practise your chess skills during lockdown. Do not hesitate to contact The Knight for chess tutoring or just to exchange some ideas about the sport of chess.

This article will not be complete without commending the HOA's contracted garden service team, Garden Creations, who had the daunting task of tidying up all the parks and gardens in the estate – this was done within two weeks since returning to their duties after a lockdown period of more than two months. The team will start with the planned winter programme during



The Garden Creations Team

July, which includes the following tasks:

- Duke Park: landscaping of existing flower beds, planting new plants and upgrading and extending the current walkway.
- Development of a new walkway in Crown Park and defining the veld area borders of the park.
- Cutting back of veld grass in certain parks.
- Pruning of the younger trees.
- Cutting down intruder trees in the veld areas (black wattle, etc.).
- Automation of the watering system for the flower beds at the two gatehouses.

We received several enquiries about the feeding of the small animals in the estate, especially during the cold winter months. With the advice from our local Vet, we will be putting out lucerne at a few feeding spots in the veld areas for the Duiker and Steenbuck, as well as two water troughs, which will be cleaned and refilled regularly.

The 2020 Annual General Meeting (AGM) is around the corner. The HOA Board is considering alternatives, should the Lockdown Regulations continue to prohibit gatherings of this nature. The members will be advised beforehand of the Board's decision regarding the manner, date and time of the AGM.

The latest tendency in the estate is that delivery men are ignoring the 40km/h speed limit in the estate. The reason for this conduct is, in all probability, caused by the many deliveries that must be made in the shortest possible time. Residents must please inform their delivery companies that the delivery person must comply with the speed limit. If a delivery person is found to be speeding, or not adhering to



Water trough



Steenbok

the general traffic rules of the estate, such person will be asked to leave the estate immediately regardless of whether the delivery was carried out or not. In such instance, the resident will have to collect the goods at the gate.

We wish all our residents a healthy time in their lives.

Best regards,

Estate Management

*"I do it because I can;
I can because I want to;
I want to because you
said I couldn't!"*

– Unknown





DARE TO LOVE

A warm word of sincere thanks to all the residents who took part in the donation programme for the needy. The Social Team was tasked with the packing and distribution of all the groceries, winter clothing and bedding. We also want to thank the residents who donated face masks to our Security personnel.

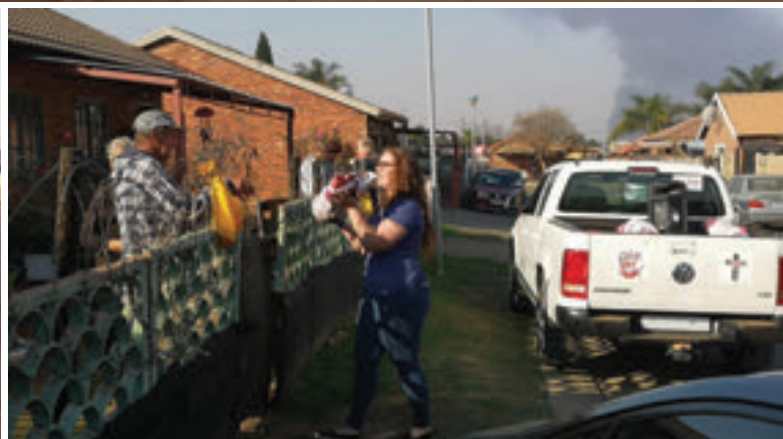

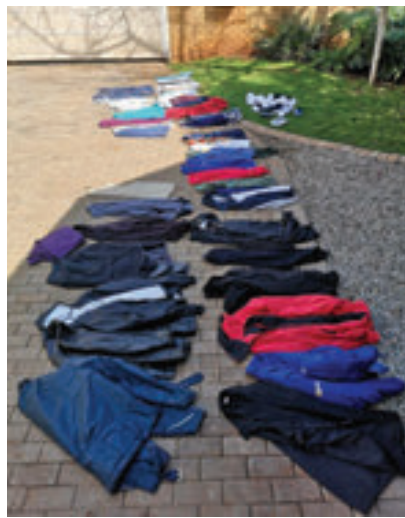



IRENE FARM VILLAGES HOME OWNERS ASSOCIATION

Summary Income Statement – May 2020

	May 2020		Year to Date		YTD Variance	
	Actual	Budget	Actual	Budget	Value	%
Operational Income						
Levy Income	1 166 332	1 166 333	3 440 820	3 440 821	(1)	0.0%
Other Income	(61 153)	32 500	162 150	217 800	(55 650)	-25.6%
	1 105 180	1 198 833	3 602 969	3 658 621	(55 652)	-1.5%
Operational Expenditure						
Professional /Administration	66 682	75 216	232 479	223 648	(8 831)	-3.9%
Accounting and Auditing	41 237	43 237	123 711	127 711	4 000	3.1%
Insurance, Legal and Admin	25 445	31 979	108 768	95 937	(12 831)	-13.4%
General Office	4 022	13 806	10 983	34 418	23 435	68.1%
Office Administration	4 022	13 806	10 983	34 418	23 435	68.1%
Operational Expenses	150 666	228 724	540 249	684 172	143 923	21.0%
Municipal Charges	30 183	47 400	87 962	142 200	54 238	38.1%
General Operations	9 908	21 003	39 724	63 009	23 285	37.0%
Salaries & Wages	110 575	160 321	412 563	478 963	66 400	13.9%
Security	466 590	491 263	1 406 878	1 448 201	41 323	2.9%
Security Operations	44 800	65 806	140 096	200 124	60 028	30.0%
Guarding Services	421 790	421 257	1 265 370	1 235 477	(29 893)	-2.4%
Insurance Claims and Excess	0	4 200	1 413	12 600	11 187	88.8%
Repairs & Maintenance	13 402	167 171	178 968	518 513	339 545	65.5%
Repairs & Maintenance	13 402	30 910	42 708	109 730	67 022	61.1%
Park Maintenance Contract	0	136 261	136 261	408 783	272 522	66.7%
	701 362	976 180	2 369 557	2 908 952	539 395	18.5%
Operating Profit / (Loss)	403 818	222 653	1 233 412	749 669		
Non-Recurring Revenue	8 260	0	17 565	0	17 565	100.0%
Non-Recurring Expenses	34 645	55 200	56 218	155 600	99 382	63.9%
Net Positive/ (Negative)	(26 385)	(55 200)	(38 653)	(155 600)	(81 817)	
Net Profit / (Loss)	377 433	167 453	1 194 759	594 069		

IRENE FARM VILLAGES HOME OWNERS ASSOCIATION

Summary Levy Statements – May 2020

	120+ Days	90 Days	60 Days	30 Days	Current	Total		Previous Month
Normal - Self Pay	-	-	50	8 529	-315 923	- 307 344		-263 339
Normal - Debit Order	-	-	-	-	- 11 187	- 11 187		-6 888
	-	-	50	8 529	-327 110	- 318 531		-270 227
Debt Collection - AA (30/60 days)	18 006	9 855	19 344	38 112	37 765	123 082	52%	335 435
Debt Collection - JJR (90+ days)	185 305	12 560	37 880	13 787	12 663	262 195	112%	249 469
Debt Collection - KSB (90+ days)	2 587	2 980	3 106	3 089	2 988	14 750	6%	16 686
Sold - Previous Owner Accounts	-	-	-	-	- 55 516	- 55 516		-55 577
In Transfer	-	-	2 544	5 648	- 3 476	4 716		-269
Other	162 273	12 569	12 591	6 706	10 315	204 453		63 270
	368 170	37 963	75 516	75 871	-322 370	235 150	-30.6%	338 788
Debt Collection - Accounts > R200,000	957 582	15 605	28 736	16 291	11 233	1 029 447	1.7%	1 012 122
	1 325 752	53 569	104 253	92 161	-311 137	1 264 597	-6.4%	1 350 910

We want to thank all members who continue to pay their monthly levies so diligently. Amidst the COVID-19 lockdown, members are paying, and many members that did fall behind in May have settled all outstanding levies. Our outstanding levies reduced by 30.6%, April to May 2020. Last month, the number of accounts owing for more than 3 months reduced from 22 to 18; 60 days - 31 to 26; 30 days - 58 to 51. Account Ability and the Estate Management are continuously driving collections to ensure adequate cash flow to fulfil the HOA obligations.

Irene Farm Villages Home Owners Association – Capital/ Development Projects

	Current Stage	Current Status	Approved Budget	Actual Spend To Date	Available Budget
Infrastructure Development	Planning		8 797 910	725 876	8 072 034
Security Upgrade Project	Define		1 700 000	1 583 234	116 766
Total			10 497 910	2 309 110	8 188 800

*“Lately,
I’ve been
losing sleep.
Dreaming
about the
things that
we could be.”*

– One Republic
– Counting Stars

Account Ability

Office Address:
Sovereign Drive,
Route 21
Corporate Park

Accounting
Office Hours
8:00 to 13:00
Monday to Friday

Office Tel: 082 780 0059

Accounts Email:
accounts@aams.co.za

IFV Accounts:
Winnie Boshoff

Summary Income
Statement by
Account Ability



DOMINATE THE PACK.



Experience adrenaline to the power of M. No other Sports Activity Vehicle combines the rugged DNA of an X vehicle and the high-performance pedigree of BMW M as skilfully as the BMW X5 M Competition. It's time to enjoy drive you deserve.

Take control at BMW Centurion. To book your test drive, call 012 683 4000 today.

BMW Centurion

2023 Lenchen Ave S, Centurion Central, Centurion

Tel. 012 683 4000

www.bmw.co.za/centurion



WHEREVER YOU GO, THERE'S MINI.

Now you can browse, customise and the MINI you've always wanted before your first cup of coffee with MINI Anywhere.

Go to buy.MINI.co.za to meet your dream MINI and collect it at MINI Centurion.

MINI Centurion

2023 Lenchen Avenue South, Centurion

Tel. 012 683 4000

**EXPLORE MINI ANYWHERE.
MINI CENTURION.**



CHESS BY



ANALYTICAL THOUGHT IN CHESS

Let us consider the following position in which White has just played Bh7 check. Black has only two options to get out of check: he can move the king to h8 or take the bishop on h7.

Before making this move, White had to analyse the results and both possible variations. We now get the tree of analysis according to Kotov. In this case, the analysis is relatively simple as it is shown on the next diagram.



During the last month I received an interesting question: How does one practise and improve one's chess during lockdown, since players cannot meet face to face over the chess board?

There are many different ways that a chess player can improve and practise his/her game without access to the internet. Let us consider the method suggested by the Russian grandmaster Alexander Kotov in his book *Think like a grandmaster*.

Kotov considers how the grandmaster thinks in a chess game and argues that during the game there are a number of different types of thought.

1. Thinking during one's own time:

This involves the recognition of tactical patterns such as the pin, knight fork, discovered attack (use of battery), double attack and certain mating patterns. The next aspect of chess thinking is analysis of possible variations which I shall examine below.

2. Thinking during your opponent's time:

During this time, the chess player should devote his thinking to strategic aspects of the game. This involves some of the following:

a. Try to control the centre from the opening to the end game – pieces that control the middle of the board are more mobile, so place your pieces on squares where they exert the maximum power.

b. An attempt to constrict your opponent's choices.

c. Long term planning – the use of small steps to achieve the ideal position.

Strategic thinking is an extremely complex topic and many books have been written about this aspect of the game, which I shall look at in more detail in future columns.

Bh7 check

Variation 1	Variation 2	Comment
Kh8	Kh7	
Bd3 – restricts the possible movement of the Black knight to C4	Ng5 check Black can either take the knight or move the king out of check	Moving the king to g6 is correct – why?
	Black chooses to take the knight with Bg5 – he is now two pieces ahead	Being greedy in chess does not help – Black should decline this second sacrifice
	Qh5 check Bh6 Bh6 Gh6	Note the king could retreat out of check and White takes the Black bishop threatening the queen
	Rf6 threatening mate	White has to now give up his queen to prevent mate and the knight at a5 is threatened

This sacrifice of White is based upon the classical bishop sacrifice and is not entirely correct but, because Black decided to be greedy, it was successful.

This is an example of what they call thinking ahead in chess. The grandmaster analyses each variation once from the beginning to the end. The problem is that certain variations are extremely complex and there are many variations. The tree of variations has many branches and seems to spread out endlessly.

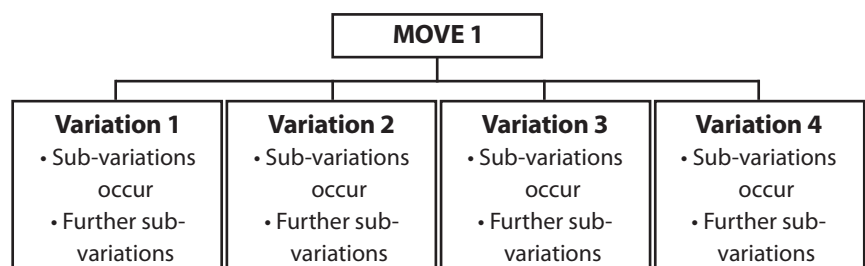

The critical question is how to put this idea of analysis into practice. There are a number of ways of doing this:

- Playing well annotated games of grandmasters such as the games of Tal and Fischer. Bobby Fischer's analysis of *My Sixty Memorable Games* is an exceptionally good book with excellent notes.
- The second method of training without the computer is to take a game played by two grandmasters and then play the game for one of the grandmasters by covering the other grandmaster's moves. You must now analyse the moves and then think about how to make the right moves. Note there will be a difference between the move you choose and the grandmaster's choices. By practising this way, you will eventually learn to make moves that are the same as the grandmaster. This takes hard work and is not easy.



AN INTERESTING STORY ABOUT ANALYSIS

Tal: "I will never forget my game with GM Vasiukov on a USSR Championship. We reached a very complicated position where I was intending to sacrifice a knight. The sacrifice was not obvious; there were a large number of possible variations; but when I began to study hard and work through them, I found to my horror that nothing would come of it. Ideas piled up one after another. I would transport a subtle reply by my opponent, which worked in one case, to another situation where it would naturally prove to be quite useless. As a result, my head became filled with a completely chaotic pile of all sorts of moves, and the infamous 'tree of variations', from which the chess trainers recommend that you cut off the small branches, in this case spread with unbelievable rapidity. And then suddenly, for some reason, I remembered the classic couplet by Korney Ivanovič Chukovsky: "Oh, what a difficult job it was. To drag out of the marsh the hippopotamus."

I do not know from what associations the hippopotamus got into the chess board, but although the spectators were convinced that I was continuing to study the position, I, despite my humanitarian education, was trying at this time to work out: just how WOULD you drag a hippopotamus out of the marsh? I remember how jacks figured in my thoughts, as well as levers, helicopters, and even a rope ladder.

After a lengthy consideration I admitted defeat as an engineer, and thought spitefully to myself: "Well, just let it drown!" And suddenly the hippopotamus disappeared. Went right off the chessboard just as he had come on . . . of his own accord! And straightaway the position did not appear to be so complicated. Now I somehow realised that it was not possible to calculate all the variations, and that the knight sacrifice was, by its very nature, purely intuitive. And since it promised an interesting game, I could not refrain from making it.

And the following day, it was with pleasure that I read in the paper how Mikhail Tal, after carefully thinking over the position for 40 minutes, made an accurately calculated piece sacrifice.



Layers of the Tank:

- Layer 1
 - Tank Colour
 - UV Protected
- Layer 2
 - Black
 - Keep sunlight out, which prevents algae growth.
- Layer 3
 - White
 - Made of Food Safe material



2000L
(W)1365 x (H)1500
30kg
Full Load Qty: 30



2500L
(W)1474 x (H)1620
35kg
Full Load Qty: 30



4000L
(W)1700 x (H)1868
58kg
Full Load Qty: 18



5000L
(W)1840 x (H)2022
70kg
Full Load Qty: 18



1600L
Slim Line / Under Eave
(W)1500x(H)2000xD(700)
47kg
Full Load Qty: 20



2500L
Split
(W)1474 x (H)2200
44kg
Full Load Qty: TBC

The First Water Tank in South Africa with:

- 3 Layer Technology
- BPA - Free HDPE Material

Blow Moulded Technology Gives You:

- Extra Strength
- Better Quality

Excellent For:

- Safe Drinking Water
- Back Up Water Storage
- Agricultural Use
- Rain Water Harvesting

Tank Colours:

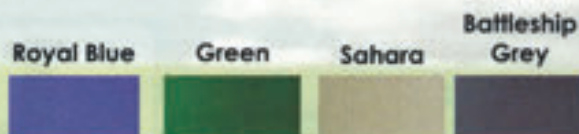

Comes standard with: A solid screw on lid, 50/40 reducer inlet, 40mm Insect Proof overflow, 50/40 reducer outlet

Take a fresh look at water tanks with the stylish NEW AFRICA TANKS, designed to save money, water and the environment.



012 362 6089



info@hilite.co.za



1093 Burnett Street, Hatfield, 0083



www.hilite.co.za

#favouritehue2020 **MULBERRY LEAF**



DESIGNED FOR *Life*

POST- LOCKDOWN SPRUCE UP!



R599

White 5L R599
Pastel Base 5L R649

R799

Alkali-resistant
primer, 20L



R55

Double Velvet, Polvin
& Micatex traysets



R349

white 5L
white 20L R1039



R59

Velvagio
Roller
Trayset



R549

White 5L R549
Pastel Base 5L R599



A PROUD MEMBER OF



www.paintclub.co.za

Promotion only valid until 31 May 2020.
While stocks last. Ts & Cs apply. E&OE



COLLABORATIVE COMMUNITY NETWORKS TO BRIDGE THE DIGITAL DIVIDE (‘The Smart Pie’)

BY DR REOLYN HEYMANN

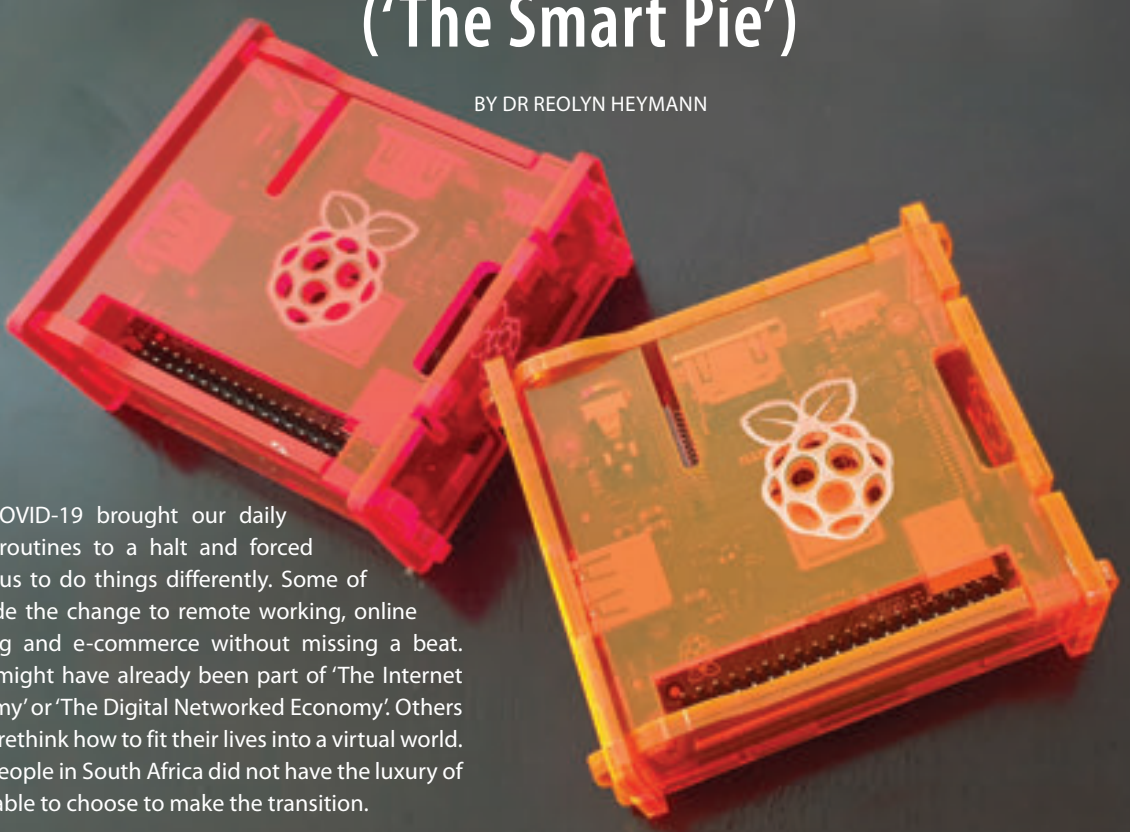

COVID-19 brought our daily routines to a halt and forced us to do things differently. Some of us made the change to remote working, online learning and e-commerce without missing a beat. Some might have already been part of ‘The Internet Economy’ or ‘The Digital Networked Economy’. Others had to rethink how to fit their lives into a virtual world. Most people in South Africa did not have the luxury of being able to choose to make the transition.

As with other areas of our lives, the lockdown highlighted the digital divide in our country. The digital divide refers to the number of people with access to high-speed internet and those without any connectivity. Lots of people, especially in rural areas, do not have access to high-speed, broadband internet. The reasons include the cost of data, access to equipment or just lack of infrastructure.

So even though all the information that learners may need to successfully complete their school year from home is available on the internet, many of them do not have access to it. Some of the data is in formats making it even more difficult to access – it is just not feasible to download a 50-minute lecture over an unstable or expensive connection.

FINDING A SOLUTION

One of the solutions is small networks to distribute learning materials. A digital network is several devices – for example laptops and cellphones – connected to each other in order to share data with other resources, like printers and scanners.

Our strength may be in how our community networks can overcome the digital divide in creative ways.

The Centre for Collaborative Digital Networks at UJ (the University of Johannesburg) has been working with an NGO in Kwa-Thema (Springs) to provide small educational networks to learners. A small server, loaded with educational learning material, is installed in public places, for example grocery stores or fuel stations. An access point allows access to anybody in the area to use the server via Wi-Fi. Learners can download important study guides and videos while shopping. The study materials can then be used at home for remote learning. The learning materials are updated regularly according to the needs of the students. Even though this system is not connected to the internet, this small network can provide free access for learners, from Grade R to Grade 12, to valuable online resources. The cost of components for each of these networks is approximately R1 000,00 procured with funding from Liquid Telecom SA.

NETWORKING

Connectivity and networking are a pillar of the Fourth Industrial Revolution. However, networking does not only apply to digital networking. The current epidemic should also force us to look at our social and community networks and investigate how we can use them to distribute resources.

Various studies have suggested that digital connectivity is an enabler of rapid development in the socioeconomic landscape, in countries where it is readily accessible. Even though we lack in infrastructure and financial resources to ensure digital connectivity for all, our strength may be in how our community networks can overcome the digital divide in creative ways.



Dr Reolyn Heymann
(D. Eng. Electrical and
Electronic Engineering)
Director: Centre for
Collaborative Digital
Networks, University of
Johannesburg

Collen
HANDYMAN

MAINTENANCE SERVICES

PAINTING
REPAIRS
MAINTENANCE
PLUMBING
PAVING
ELECTRICAL
INSTALLATION

24HR FIX-IT SERVICES FOR
EMERGENCIES TO RESIDENTS IN
PRETORIA, CENTURION AND
SURROUNDING SUBURBS

CALL US TODAY!
071 286 8806

Renovation & Maintenance Experts

W: www.0861nutsman.co.za
C: 082 366 6911
E: info@0861nutsman.co.za

0861 NUTSMAN
0 8 6 1 6 8 8 7 6 2 6

Maintenance, Steel Work, Carpentry, Electrical, Plumbing, Building, Painting, Security, Roofing

CO-CLEAN™
PROUDLY POWERED BY Zolite

PROFESSIONAL CLEANING SERVICES

RESIDENTIAL	COMMERCIAL	SANITATION
Full House Cleaning Mattress Carpet & Tile Cleaning Windows Post and Pre Occupation MasterGuard Shower & Upholstery Cleaning	Office Cleaning Pre or Post Construction Restroom Cleaning Flood Extraction Tile & Carpet Cleaning Office Furniture Cleaning Windows	We offer commercial, educational and residential sanitising services, using only professional grade all natural chemicals of the highest quality.

ENQUIRE FOR PRICING AND BOOKINGS

RYAN MASSIE c. 073 910 2953 | e. ryan@coclean.co.za
GREG GERICKE c. 083 378 4243 | e. greg@coclean.co.za

www.coclean.co.za

BUILD INN
INDUSTRIAL DOORS **WILT TO LAST**

012 804 3595
082 891 7534
service@buildinn.co.za
282 Calvyn Str
Silverton 0127
www.buildinn.co.za

Xpanda
Real Security

30 YEARS
1984 - 2014

- ~ Residential Garage Doors
- ~ Commercial and Industrial Doors
- ~ Automation
- ~ Security Barriers (Xpanda Security)
- ~ Block House Shutters

SERVICE AND REPAIRS

MTN EverydayGigs

new

MTN EverydayGigs

Join MTN, buy once and get **1Gig every day**

7Gigs/7Days/R149

30Gigs/30Days/R499

Dial *136*2#



We're good together everywhere you go



Terms and conditions apply. *Based on the MyBroadband Mobile Network Quality Report South Africa Q4 2019. For full Terms and Conditions, visit mtn.co.za. E&OE.

ARE WOMEN REALLY FROM VENUS?

BY JAMES CLARKE



There are now as many as 60 female heads of government in the world. In 1960, there was but one: Sirima Bandaranaike, Prime Minister of Sri Lanka (then Ceylon).

As more and more women are heading governments and filling more and more cabinet posts, one is tempted to ask - will it make international relationships more tolerant? Will there be less war talk?

Are women really gentler?

In the 1990s, Dr John Gray, an American relationship counsellor, wrote *Men are from Mars, Women are from Venus* inferring that women do have gentler natures. Somebody then cited an incident where English department students at California State University were asked to pair off. One had to write the opening lines of a short story; the partner then added the next few lines. Then back to the first person who continued the story, and so on.

Lisa paired up with Dave.

Lisa: At first, Laurie couldn't decide which kind of tea she wanted. The camomile, which used to be her favourite for lazy evenings, now reminded her too much of Carl, who once said in happier times that he liked camomile. But she felt she must keep her mind off Carl. His possessiveness was suffocating, and if she thought about him too much her asthma started acting up again. So camomile was out of the question.

Dave: Meanwhile, Advance Sergeant Carl Harris, leader of the attack squadron now in orbit over Skylon 4, had more important things to think about than the neuroses of an air-headed asthmatic bimbo named Laurie with whom he had spent one sweaty night a year ago. "A.S.

Harris to Geostation 17," he said into his transgalactic communicator. "Polar orbit established. No sign of resistance so far . . ." but before he could sign off, a bluish particle beam flashed out of nowhere and blasted a hole through his ship's cargo bay. The jolt from the direct hit sent him flying out of his seat and across the cockpit.

Lisa: He died almost immediately, but not before he felt one last pang of regret for psychologically brutalising the one woman who had ever had feelings for him. Soon afterwards, Earth stopped its pointless hostilities towards the peaceful farmers of Skylon 4. "Congress Passes Law Permanently Abolishing War," Laurie read in her newspaper one morning. The news simultaneously excited her and bored her. She stared out the window, dreaming of her carefree youth - with no newspapers to read, no television to distract her from her sense of innocent wonder at all the beautiful things around her. "Why must one lose one's innocence to become a woman?" she pondered wistfully.

Dave: Little did she know, but she had less than 10 seconds to live. Thousands

of miles above the city, the Anu'udrian mothership launched the first of its lithium fusion missiles. The dim-witted wimpy peaceniks who pushed the Unilateral Aerospace Disarmament Treaty through Congress had left Earth a defenceless target for the hostile alien empires who were determined to destroy the human race. Within two hours after the passage of the treaty the Anu'udrian ships were on course for Earth, carrying enough firepower to pulverise the entire planet. With no one to stop them, they swiftly initiated their diabolical plan. The lithium fusion missile entered the atmosphere unimpeded.

The President, in his submarine headquarters on the ocean floor off Guam, felt the inconceivably massive explosion which vaporised Laurie and 85 million other Americans. The President slammed his fist on the conference table: "We can't allow this! I'm going to veto that treaty! Let's blow 'em out of the sky!"

Lisa: This is absurd. I refuse to continue this mockery of literature. My writing partner is a violent, chauvinistic, semi-literate adolescent.

Dave: Yeah? Well, you're a self-centred, tedious neurotic whose attempts at writing are the literary equivalent of Valium.

Lisa: Idiot!

Dave: Bitch!

(*Quod erat demonstrandum.*)

But I bet they dated afterwards.

TRANSFORM YOUR BODY, TRANSFORM YOUR LIFE!

ENTER THE BODY20 FOR LIFE TRANSFORMATION CHALLENGE &
WIN PRIZES TO THE VALUE OF R50 000.

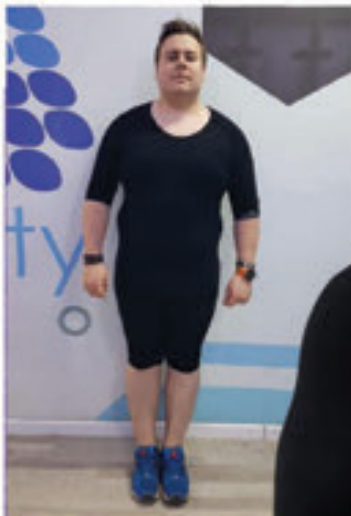

BEFORE

BODY20.CO.ZA



MARKO KOTZE

LOST 45.8KG
IN 12 MONTHS

2019 WINNER



A STRONGER, FITTER YOU
IN ONLY 20 MINUTES PER WEEK



064 159 7480



irene@body20.co.za



Shop 134, Irene Village Mall,
C/O Nellmapius &
Pierre van Ryneveld Roads,
Irene, 0157



www.body20.co.za



Terms & conditions apply.

WATERGUARD



Swimming is a lot more
fun with water in the pool

- ✓ environmentally friendly, non toxic clear liquid
- ✓ apply 1ml per sqm of surface area
- ✓ non-harmful to plant, marine and aquatic life
- ✓ evaporation savings of 50% and above
- ✓ spreads across the surface to form a thin layer
- ✓ water evaporates at an average rate of 8 litres per sqm per day



50ml

500 ml

1 litre

www.hilite.co.za



email: info@hilite.co.za



tel: +27 12 362 6089

1093 Burnett street, Hatfield, 0083

Smalls

If you would like to advertise in our smalls section, please contact us: Tel: 012 662 3505, email: admin@irenefarmvillages.co.za
KINDLY NOTE: ALL SMALLS ADVERTISEMENTS NEED TO BE RESUBMITTED EVERY MONTH.

SERVICES

Art classes in Irene Farm Villages! Come and join to explore your creative side, guided by an experienced artist. Classes for kids 10 years and up, and adults, 2 hours per week, all materials included. Please e-mail joubert.ladine@gmail.com or call 079 496 1863.

Babysitting service. Need a babysitter any time during the week or over a weekend? I am available 24/7. I have babysitting experience and I am passionate about children. Contact: Liashna on 082 371 3958 / WhatsApp: 079 333 0532.

House Checking: Concerned about your house when you're away? I check your house, electricity, swimming pool, inside pot plants, etc. as per agreement. Call me: Michiel on 071 016 0913 / 082 448 5844.

Need homework help? Are you tired from a long day of work and have the added burden of online schooling and homework? Look no further. I am available to help with your child's homework 5 days a week and over weekends. I will provide assistance with speech writing, school projects and test preparation. Assistance provided for children from

Grade 3 up to Grade 7. Contact: Liashna on 082 371 3958 / WhatsApp: 079 333 0532.

Need someone to look after your dogs while you're away? We can help! Our service includes feeding, walking and loads of love, cuddling and playing. We love dogs! WhatsApp Nico on 082 799 5887 or Willem on 082 799 5884. We both live in the estate. Nico (24) works from home and Willem (21) is a student.

Pet sitting: Make it easy for yourself when going away. I care for your pets in the comfort of your home while you are away. I have been doing this for the last 10 years and have references in and outside the estate. Call me: Michiel on 071 016 0913 / 082 448 5844 (www.MyPetCare.co.za).

Tutor: All grades - English, Afrikaans, LO, CAT, Business, History. Study and homework help, tutoring, help with projects and assignments, proofreading and creative writing assistance. Grades 1 - 12. I have tutored in the estate for over 5 years and at the University of Pretoria for 3 years. Contact Holly on 071 895 9032 or hollyanne.t@gmail.com.

FOR HIRE

Jumping castles, tables and chairs, gazebos, kiddies' tables and chairs for hire @ 42 Country Club Avenue, IFV. Contact Werda on 082 822 8659 or visit www.creativecastles.co.za.

FOR SALE

Humble Honey. 100% pure organic honey. 1 kg tub or squeeze bottle for R135,00 & 1,5kg for R180,00. Call Christa for orders on 083 388 4736.

DOMESTIC SERVANTS

Joyce is seeking work from Monday to Friday in the estate. Please call her on 062 114 9386.

Siniwile is seeking work from Monday to Friday in the estate. Please call her on 061 294 1727.

GARDENER

Philimon has been working for us for more than 6 years and is also working for other families in the estate. He has Thursdays available to take on work. He is also good at doing all kinds of odd jobs around the house and does waterproofing of roofs in the estate. For more details and a reference please phone Susan on 082 8515 711, or call Philimon directly on 083 540 9365.

my at home

PASTORS BERT AND CHARNÉ PRETORIUS

JOIN US FOR
CHURCH ONLINE
EVERY SUNDAY

CONNECT HERE

GAU TV DStv
CHANNEL 265
10am

MY3C.TV
08am | 10am | 12pm | 05pm



ACCREDITED ESTATE AGENTS

apple
PROPERTY CONNECTION

Your Real Estate Agent

Melanie Burrell
082 653 5568
melanie@appleproperty.co.za
www.appleproperty.co.za

BuySell
THE REAL ESTATE COLLECTION

Principal: Nina Antoniou
Agent: Nina Antoniou Cell: 082 963 1994
Rental Agent: Eunice Cell: 071 676 5940
Office: 012 667 3692
Fax: 086 617 0516

LÉANE GRAAFF
PROPERTY SPECIALIST

SALES • RENTALS
VALUATIONS • FINANCE

083 457 3184

leapfrog
PROPERTY GROUP

Steven Kruger
082 699 4881
steven.kruger@leapfrog.co.za

PAM GOLDING
PROPERTIES

Principal: Retha Schutte
Office: 012 644 8300
Agent: Peter Varrie
Cell: 082 457 7416
peter.varrie@pamgolding.co.za

RealNet
Ultimate properties

Independently owned and operated franchise

Marius Minnie
083 640 2222
mariusm@realnet.co.za
www.realnet-ultimate.co.za
www.realnet.co.za

RM REALTORS
SALES RENTALS COMMERCIAL DEVELOPMENT

Machelle Henning-Walker
OWNER / PRINCIPAL
Cell: 082 789 7888
machelle@rmrealtors.co.za
www.rmrealtors.co.za

Seeff
Expertise Built Through Generations of Trust

Principal: S.J. van Wyk 082 454 9813
Sylvia Meneely 084 010 8504 sylvia.meneely@seeff.com
Ronell Venter 082 302 8924 ronell.venter@seeff.com
Office: 012 667 2167 • Fax: 012 667 3566
www.Seeff.com

SUPERIOR REALTY

Jonathan Koen
Cell: 073 206 3877
www.superiorrealty.co.za
jonathan@superiorrealty.co.za

**PLEASE
SUPPORT
OUR
APPROVED
ESTATE
AGENTS**

SANITISING AND DISINFECTING THE NEW NECESSITY

COVID-19
HEALTH & SAFETY
COMPLIANT SERVICES

FOGGING, DISINFECTING, SANITISING,
All products used are 100% Natural

ENQUIRE FOR PRICING AND BOOKINGS

RYAN MASSIE c. 073 910 2953 | e. ryan@cocleansa.co.za
GREG GERICKE c. 083 378 4243 | e. greg@cocleansa.co.za

CO-CLEAN™
PROUDLY POWERED BY Zippi

www.cocleansa.co.za

DENTAL
BOUTIQUE

SPECIALIZED DENTISTRY
FAMILY DENTISTRY
ORTHODONTICS

Centurion Gate Centre
012 6633 590
info@centuriondentist.co.za
www.dentalboutique.co.za

IMPORTANT NUMBERS

Police Emergency	10111
Lyttelton Police Station	012 644 8600
Pierre van Ryneveld Community Policing Forum	079 528 1630
Fire Emergency	10177
Medical Emergency	082 911
Security at Gates	012 662 3505 ext 3
Protea Coin Shift Manager	082 838 7779
Irene Farm Controller	082 947 7610
Irene Farm Villages:	
Estate Office	012 662 3505
Estate Manager	079 525 9281
Assistant Estate Manager	083 274 8829
Managing Agent: Account Ability	
• Tel: 082 780 0059 • Fax: 086 671 9798 • info@aams.co.za	

IRENE SERVICE PROVIDERS



MEDICAL SERVICES

BLOOD HEALTH & ACUTHERAPY

100% NATURAL HEALING FOR HEALTH & LONGEVITY. Nutritional microscopy, kinesiology, comra and ozone therapy plus various detox methods. For appointments call 083 612 0427 or email: info@livebloodacupressure.co.za

DENTAL CARE

Irene Village Care, general dentistry and more. Irene Corporate Corner. Call: 012 662 0302 / 079 069 4607 info@irenecare.co.za www.irenecaredentist.co.za

DR CHRISTA ROCHER

Your GP in Irene Village Mall. Family health, child health, women's health. Call: 012 662 0305 Info@christacare.co.za www.christacare.co.za

TRANSPORT SERVICES

COLETTE DIRKS AIRPORT SHUTTLE SERVICE AND TRANSPORT TO AND FROM ST ALBAN'S COLLEGE.

Bus leaves from main gate at 06h30. Pick up from St Alban's in the afternoon. Contact Colette at 082 415 3830.

FINANCIAL SERVICES

FINANCIAL PLANNING

Professional advice on all personal and business-related insurance needs. **Personal:** Medical Aid, Funeral, Life Cover, Short Term Insurance, Investments. **Business:** Group Benefits, Company Agreements, Business Contingency, Commercial Insurance. Contact us: riaan@netactive.co.za / hilda.muller@netactive.co.za 084 653 6299 / 083 653 6299 / 012 348 1239. Office hours: 08h00 – 16h00.

GENERAL SERVICES

BRAAI WOOD FOR SALE

Best quality "sekelbos" wood at a reduced price of R 19.99 per bag. We supply and deliver to your home in Irene Farm Villages. Just phone Cobus on 072 606 2053 to arrange your order. *Nou gaan ons BRAAI !!!*

LILLIPUT EARLY LEARNING

Let your child fulfil their potential in a friendly, spacious environment. Safely situated within Cornwall Hill Country Estate. Small classes ensure individualised attention. Bilingual, 18 months – 4 years of age. Please contact Suzette: 083 564 3298 or lilliputearlylearning@gmail.com

LITTLE EINSTEINS PLAYSCHOOL

- ★ Established in 2003
- ★ Cornwall Hill Estate
- ★ Ages: 2-6 years
- ★ Phenomenal Grade 0 year
- ★ Highly qualified Educators
- ★ Small group teaching
- ★ Contact: Sharon Rosema 082 904 8157

PHOTOGRAPHY

LOOKING FOR A PHOTOGRAPHER?

See my portfolio here at www.ivanmullerphotography.com. If you like what you see, contact Ivan at 082 454 8487 or ivanmuller@icon.co.za. I have a large format photo quality inkjet printer that can print on canvas and fine art paper up to size A0. I am also available for any type of location photography.

HOME SERVICES, BUILDING & MAINTENANCE

ALTOKLEEN (1979)

Supervised quality cleaning and pest control 072 349 8787/ 082 395 6449 open Mondays – Saturdays and Festive Season. Carpets, loose rugs, upholstery, leather, windows, spring cleaning. Info@altokleen.co.za Pretoria, Centurion, Midrand

BOTSELO'S CURTAIN BOUTIQUE

We offer a professional service from Blinds and Curtains to rods, shutters, wallpaper, etc. With a wide variety of fabrics and styles available, we will find the perfect colour, style and design to meet your specific needs. Come visit our showroom or contact us to experience the full spectrum of services on offer. All your decorating needs under one roof, from consultation to installation. 012 663 8091. Email: botselos@botselos.co.za.

CREATIVE WOODWORKS & ALU

Specialising in repairs and maintenance of all windows, doors, decks, pergolas and more. New installations and custom joinery. Professional service guaranteed. Kobuslange@yahoo.com 074 615 8579 or 079 632 5331



CHEMDRY

Convenient appointments, deep cleaning of carpets & upholstery. Chantel 012 663 8531 / 082 372 4999.

ELECTRICAL INSTALLATION SERVICES (EIS)

EIS is a BBBEE compliant company, established in 1997. We are a full service electrical contracting company, with over 20 years' experience in the electrical industry. We do COC's, All Electrical Maintenance and Construction, Specialised Lighting, Air Conditioning, Solar PV Installations. Tel: 012 662 0787 • Fax: 086 541 0685 Cell: 079 503 0944 • Email: estelle@e-i-s.co.za Website: www.eiselectrical.co.za

HOME SERVICES, BUILDING & MAINTENANCE

MAHANRU WINDOW CLEANING SERVICES

Eco friendly. We clean windows with purified water through a waterfed pole system. Residential homes and office blocks up to 3 storeys. We also clean solar panels, canopies, awnings and skylights. Contact Ruan 081 530 3807 or Magda 065 873 6338.

0861NUTSMAN

Renovation & Maintenance Specialists in Waterproofing, Maintenance, Welding, Carpentry, Electrical, Plumbing, Building, Painting, Security, Roofing. Contact Tobie 082 366 6911 for a free quotation.

PLUMBING – PLUMB AVID

Drains, leaks, maintenance, installations. 012 654 2513.

LIFESTYLE HOME GARDEN

Indigenous and exotic plants, home décor and restaurants. 011 792 5616.

MADISON FLOWERS

Fresh floral arrangements. 012 667 1802 / 082 873 3797.

GARDENING AND LANDSCAPING

MELIA GARDENS

Would you like to have a beautiful garden? Our professional, reliable garden service company can assist you. We have over 16 years' experience and also offer pool maintenance services. Contact us for a quotation and see how we can maintain your garden and make it flourish! Amelia 083 326 4210. E-mail: gardenlady@mweb.co.za

MONAVONI NURSERY

Landscaping, irrigation, nursery. 012 668 1261.

RESTAURANTS

MEADOW GREEN RESTAURANT

012 667 6464.



Hayden Lansdell, CFP®

MCorn (UP)
Director

hayden@ecwealth.co.za
+27 71 6733 633

Tax Planning & Financial Planning

- Independent & Holistic Financial Advice
- Cash Management & Investments
- Pre & Post Retirement
- Long Term Risk Solutions
- Tax Planning

Epiphany Capital Wealth (Pty) Ltd is an authorised financial services provider #50053. We provide unbiased and independent financial and tax advice, centred around your individual needs.



Authorised Financial Services Provider #50053

AMBIA-LINE – Organisation at its best

Store and carry your dinner plates with Blum's handy plate holders. Perfect for neat and safe storage inside a drawer. Carry up to 12 stacked plates to your outdoor dining table.

www.blum.com/ambialine

Visit our showrooms
Sandton (011) 444 8118
Cape Town (021) 555 2282
Durban (031) 579 2620
Port Elizabeth (041) 581 0219

www.eclipsegroup.co.za/

➤ More information

BORN TO BE FED

LUXURY IN CAT FOOD



BON APPÉTIT cat food is a gourmet meal created with the essence of decadence. The range features mousse and paté with irresistible flavour options. True mealtime indulgence to make your cat whisper "meow".

